

LAMINATOI A MOTORE DA BANCO

BENCH TOP ELECTRIC ROLLING MILLS - LAMINOIR MOTORISE DE BAN - LAMINADORES A MOTOR DE BANCO

Sono laminatoi elettrici ottenuti applicando, ai normali laminatoi manuali, un motoriduttore di costruzione robusta ed affidabile, esente da manutenzione in quanto lubrificato con uno speciale olio sintetico garantito a vita.

Disponibili solo con motore monofase (voltaggio a richiesta) di Hp 1,5, hanno la scatola dei comandi elettrici, tutti a pulsante, applicata sulla carcassa del motore, in posizione comoda e facilmente accessibile.

Muniti di protezioni sull'apertura dei cilindri, rispondono appieno alle vigenti normative in materia di sicurezza e prevenzioni infortuni.

They are electric rolling-mills obtained by application to normal manual rolling-mills, of a motor-reduction gear of stout and reliable construction, free from maintenance requirements since lubricated with a special synthetic oil guaranteed to life. Available with monophase motor only (voltage on request) of 1,5 HP, they have an electric control box with all controls commanded with push-buttons, applied on the motor carcass, in a comfortable position with easy access.

Provided with protections on the cylinders opening, they fully meet with the regulations in force regarding safety and accidents prevention.

Ce sont des laminoirs électriques obtenus en appliquant, aux laminoirs manuels normaux, un motoréducteur de construction robuste et fiable, ne nécessitant pas d'entretien étant donné qu'il est lubrifié avec une huile synthétique spéciale garantie à vie.

Disponibles seulement avec moteur monophasé (voltagge sur demande) de 1,5 CV, ils ont leur boîte de commandes électriques, toutes à bouton-poussoir, appliquée sur la carcasse du moteur, en position commode et facile d'accès.

Munis de protections sur l'ouverture des cylindres, ils répondent totalement aux normes en vigueur en matière de sécurité et de prévention des accidents.





Son laminadores eléctricos fabricados aplicando a los normales laminadores manuales un motorreductor sólido y fiable, que no necesita mantenimiento pues está lubricado con un aceite sintético especial garantizado indefinidamente.

Están disponibles sólo con motor monofásico (voltaje a petición) de 1,5 HP, poseen la caja de mandos eléctricos, todos de pulsador, aplicada sobre la carcasa del motor, en posición cómoda y de fácil acceso.

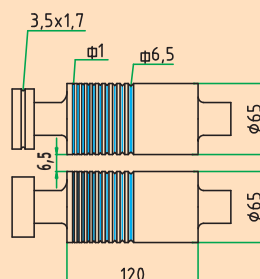

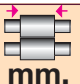
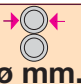
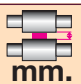

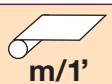
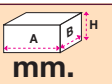
Constan de protecciones en la apertura de los cilindros, responden plenamente a las vigentes normas en materia de seguridad y prevención contra accidentes.

LB120LF

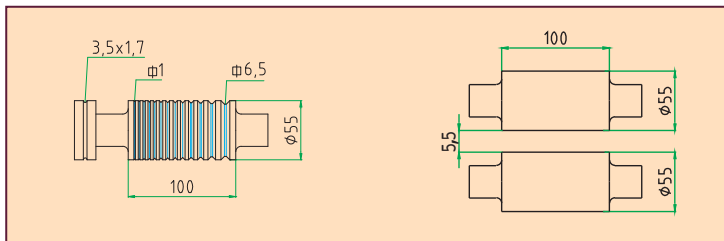

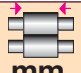
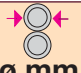
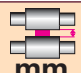
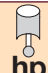
COD.	 mm.	 ø mm.	 mm.	 hp	 rpm	 m/1'	 mm.	 Kg
LB120LF	120	65	6.5	1,5	23	4,7	465x300x500h	85

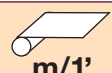
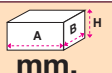

COD.	 mm.	 mm.	 mm.	 hp	 rpm	 m/1'	 mm.	 Kg
LB100DP	100	55	5.5	1,5	23	4	720x300x500h	108





Tavolini adatti a tutti i tipi di laminatoi a motore da banco.

Tables suitable for all types of bench top rolling mills.

Tables indiqu e pour tous les mod eles des laminoirs motoris e de banc.

Tablas peque as para todos los tipos de laminadores de mesa a motor.

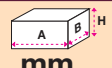

COD.	 mm.	 Kg
TVL120	480x320x850H	20
TVL100	740x320x850H	28

La serie "VARISPEED" prevede l'applicazione di un inverter per poter variare con facilità la velocità di rotazione dei cilindri da un minimo di 15 (ideale per la laminazione della lastra) ad un massimo di 35 giri al minuto (velocità indicata per il filo) senza perdere potenza ai bassi regimi. Sono disponibili due versioni: il modello LB120VS con cilindri da 120 mm per lastra e filo combinati ed il modello LB100VS da 100 mm per lastra e filo separati, entrambi ad alimentazione elettrica monofase.

On series "VARISPEED" provision is made for the application of an inverter in order to easily vary the rotation of the cylinders from a minimum of 15 rpm (ideal for the sheet rolling) to a maximum of 35 rpm (speed suitable for thread) without losing power at low speeds.

Two versions are available: model LB120VS with 120 mm cylinders for combined flat and wire, and model LB100VS with 100 mm cylinders for separated flat and wire, both with unphased power feeding.

Sur la série "VARISPEED" est prévue l'application d'un inverseur pour pouvoir varier facilement la vitesse de rotation des cylindres d'un minimum de 15 tours (idéale pour le laminage de la feuille) à un maximum de 35 tours par minute (vitesse indiquée pour le fil) sans perdre de puissance à bas régimes. Deux versions sont disponibles: le modèle LB120VS avec des cylindres de 120 mm pour feuille et fil combinés et le modèle LB100VS de 100 mm pour feuille et fil séparés, l'un et l'autre avec alimentation électrique.





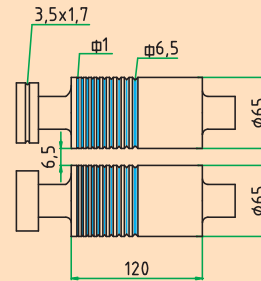

En la serie "VARISPEED" está prevista la aplicación de un inverter para poder variar con facilidad la velocidad de rotación de los cilindros de un mínimo de 15 (ideal per laminar la chapa) a un máximo de 35 revoluciones por minuto (velocidad indicada para el hilo) sin perder potencia en regímenes bajos. Están disponibles en dos versiones: el modelo LB120VS con cilindros de 120 mm para chapa e hilo combinados y el modelo LB100VS de 100 mm para chapa e hilo separados, ambos con alimentación eléctrica monofásica.

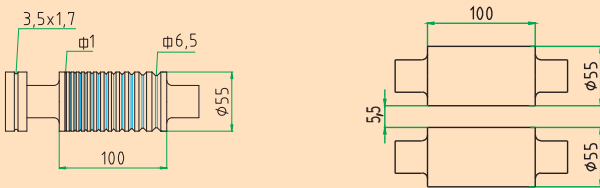
LB120VS

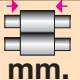

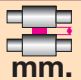
LB100VS

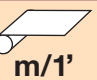
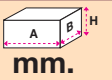

COD.	 mm.	 ø mm.	 mm.	 hp	 rpm	 m/1'	 mm.	 Kg
LB120VS	120	65	6,5	1,5	15-35	3,06-7,1	465x350x500h	88
LB100VS	100	55	5,5	1,5	15-35	2,6-6,04	720x305x500h	111